

# LPS - Sunset HID / FLUORESCENT

Project Name	Type
Catalog Number	



Sun-3 shown

## Dimensional Drawings

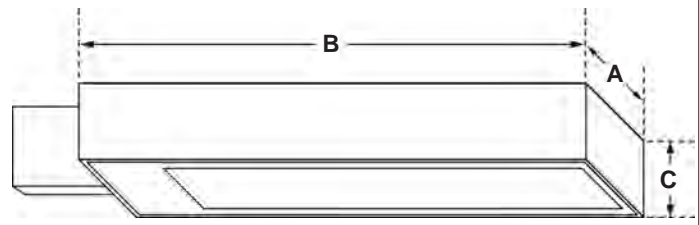



Fixture	A	B	C	Max. Watts	Lbs
SUN-1	15"	24"	9"	55 W	45
SUN-2	15"	29"	9"	90 W	50
SUN-3	20"	29"	9"	2 x 90 W	60
SUN-4	15"	52"	9"	180 W	70
SUN-6	15"	57"	6"	216 W	44

The **LPS Sunset** family of Low Pressure Sodium luminaires is designed to maximize the benefits of Low Pressure Sodium light sources with unmatched lumens per watt while eliminating glare with IES full cutoff optics. The instant on off control and the high CRI rating make fluorescent lamps a popular choice for many applications.

The **LPS Sunset** family is available in five sizes of housings with arm or yoke mount options. Two reflector options are available with a Type III providing an asymmetrical distribution, and a Type IV providing a forward throw distribution pattern. A durable polyester powder coat finish is available in a variety of architectural colors.

Lamp wattages range from 55 watts to 180 watts of Low Pressure Sodium lighting; or 64–216 watts of Fluorescent lighting. A popular version of the **LPS Sunset** fixture is the twin-90 watt luminaire which utilizes two-90 watt lamps mounted side-by-side, enabling the use of a standard shoebox design which coordinates well with most architectural applications.

Low Pressure Sodium lighting is the community standard for a number of areas where observatories are located. The International Dark-Sky community favors the use of this light source for all types of outdoor lighting. Street lighting, roadways, bridges and general area lighting are ideal applications for the **LPS Sunset** family of fixtures.

Model	Optics	Wattage	Source	Voltage	Mounting	Finish	Options
SUN-1	Type III *For BOA only (T3) 	55 (55)	LPS (L)	120 (1)  208 (2)  240 (3)  277 (4)  480 (5)	Bolt-On Arm (BOA)  Parallel Pole Mount (PPM)  Yoke Mount (YM)  Wall Mount *Cast Wall Plate (BAWP) to be ordered separately. Standard length for WM bolt-on arm is 6". (WM)	Bronze (BZ)  Black (BK)  White (WH)  Forest Green (FG)  Grey (GY)  Silver Metallic (SL)  Custom Color (CC)	<u>Photocell &amp; Receptacle</u> *Specify voltage (PC120) (PC208) (PC240) (PC277) (PC480)**  Photo Receptacle *With shunting cap (PER)  <u>Fusing</u> *Specify voltage Single in-line fuse (SF120) (SF277) Double in-line fuse (DF208) (DF240) (DF480)**  Terminal Block (TB)  Cast Wall Plate (BAWP)  Internal Light Shield (ILS)  Dual Circuit *Fluorescent only. Requires two ballasts. (DS)  Emergency Battery Pack *Fluorescent only. Provides a minimum of 90 minutes of illumination during power outages (EBP)  **not available for fluorescent sources.
SUN-2	Type IV *With parallel pole or wall mount only (T4) 	90 (90)					
SUN-3		2 x 90 (2x90)					
SUN-4		135 (135)  180 (180)		M-Tap *Multi-Tap ballast wired at 277 V unless specified (6)  347 (8)			
SUN-6	Type III *With BOA or yoke mount only (T3FL)  Type IV *With parallel pole mount only (T4FL)	(2)F32T8HO835 (2F32) (4)F32T8HO835 (4F32)  (2)F54T5HO835 (2F54) (4)F54T5HO835 (4F54)	Fluorescent *120v-277 V universal voltage (F)	120-277 *Universal voltage (UNV)			

For more detailed information on mounting, wiring or installation instructions, please consult factory. If poles are not ordered with fixtures, please specify mounting requirements. This document contains proprietary information of Visionaire Lighting, LLC. Any use of this information requires the written approval of Visionaire Lighting, LLC. In keeping with our TQM policy of continuous improvement, Visionaire reserves the right to change any specifications contained herein without prior notice.



19645 Rancho Way • Rancho Dominguez, CA • 90220  
Tel: (310) 512-6480 • Fax: (310) 512-6486  
www.visionairelighting.com

# LPS - Sunset HID / FLUORESCENT

## Housing

- The **LPS-Sunset** is precision CNC sheared and formed aluminum. Available in five sizes.
- All hardware is rust-resistant stainless steel.

## Lens and Door Assembly

- Hinged door frame is fully gasketed. A one-piece extruded silicone gasket seals the door frame against the housing.
- The lens is clear, impact resistant Lexan, secured with galvanized lens retainers, and sealed with form-fitting silicone gasketing. Size III lens is glass.

## Optical System

- Reflector is precision CNC cut and bent, multifaceted, segmented, 95% reflective aluminum reflector for IES Type III and IV light distribution patterns.

## Quali-Guard® Finish

- The finish is a Quali-Guard® textured, chemically pretreated through a multiple-stage washer, electrostatically applied, thermoset polyester powder coat finish, with a minimum of 3-5 millimeter thickness. Finish is oven-baked at 400 °F to promote maximum adherence and finish hardness. All finishes are available in standard and custom colors.
- Finish is guaranteed for two (2) years.

## Mounting

- A rounded extruded aluminum, Bolt-On Arm (BOA), with an in-pole nut plate, securing two half-inch zinc running bolts, with stainless steel hardware is standard. A Round Pole Plate Adaptor (RPP) is required for mounting to 3" - 5" round poles.
- Available in yoke mount or parallel pole mount as well.

## Electrical Assembly

- All ballasts are premium-grade HPF high-reactance autotransformer, factory wired and tapped to voltage requirement.
- LPS lamps from 55 through 180 watts, providing high lumens per watt, superior energy efficiency and quick restrike.
- T5 high output linear fluorescent lamps utilize high efficiency, high power factor electronic ballasts. Minimum start temperature is -22 °F / -30 °C

## Options

- Photocell & receptacle
- Photo receptacle
- Fusing
- Terminal block
- Cast wall plate
- Internal light shield
- Dual circuit
- Emergency battery pack

Please consult factory for custom options.

## Listings

- **Sunset** is  listed, suitable for wet locations.
- Dark-Sky Friendly®, full cutoff certified by the International Dark-Sky Association.
- Powder Coated Tough™ 

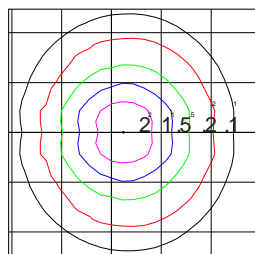

**LPS-SUNSET-6**  
ISOLUX CURVE  
TYPE III  
FLUORESCENT OPTICS  
FOUR 54-WATT T5HO LAMPS

Scale: 1 Square = 31 ft  
Initial Light Loss Factor = 1.00  
Mounting Height = 31 ft  
Arm Length: 6 ft  
Arrangement: Single

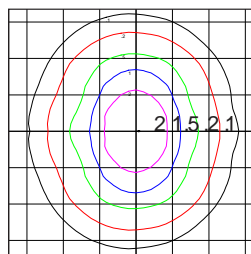

**LPS-SUNSET-3**  
ISOLUX CURVE  
TYPE III  
LPS OPTICS  
TWO 90-WATT LAMPS

Scale: 1 Square = 28 ft  
Initial Light Loss Factor = 1.00  
Mounting Height = 28 ft  
Arm Length: 1 ft  
Arrangement: Single

## Bolt-On Arm Detail Cast Wall Plate

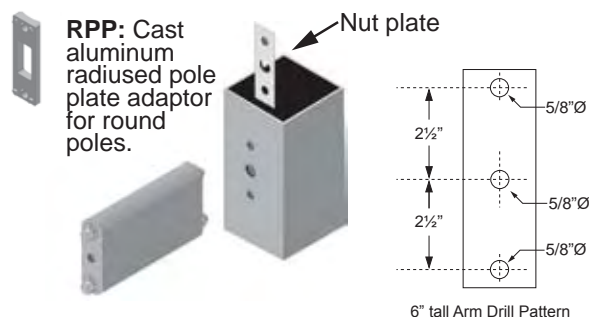

6" or 10" long x 6" tall x 2" wide for **Sun-1** through **Sun-4**.  
**Sun-6** comes w/2x4 BOA.

## Cast Wall Plate

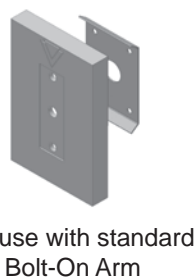





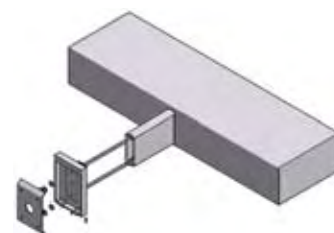

**BAWP:** 10" tall x 6 1/2" wide

## Parallel Mounting Detail



## EPA Data

Fixture with Arm						
<b>SUN-1</b>	2.0	3.4	4.0	4.9	4.7	4.9
<b>SUN-2</b>	2.3	3.9	4.6	5.5	5.3	5.5
<b>SUN-3</b>	3.1	5.3	6.2	7.5	7.2	7.5
<b>SUN-4</b>	3.7	5.4	7.6	10.2	9.9	10.2
<b>SUN-6</b>	2.6	4.8	5.2	7.2	7.0	7.2



19645 Rancho Way • Rancho Dominguez, CA • 90220  
Tel: (310) 512-6480 • Fax: (310) 512-6486  
www.visionairelighting.com